



GOVERNMENT CENTER AMPHITHEATER

TECH **PACK**



GENERAL INFO

ADDRESS

Clark County Government Center Amphitheater
500 S. Grand Central Parkway
Las Vegas, NV 89154

ABOUT

The Amphitheater is conveniently located off two main freeways and can be host to your next festival or community event. The Amphitheater is 280 feet in diameter and located on an acre and a half of land under the gaze of canyon rock and the prickly pear façade. The outdoor Amphitheater is operated by the Clark County Department of Parks and Recreation. It is home to some of the Valley's best live performances, including the annual free Jazz in the Park series. The Amphitheater is also available for rental by groups and businesses for events such as cultural festivals, theatrical performances, and other community-based functions.

**[CLICK HERE FOR
VENUE RATES](#)**

DIRECTIONS

FROM I-15 SOUTH

- Take Exit 44 onto Washington Ave toward D street, City Parkway
- Turn left onto D street
- Keep right unto W. Wilson Ave.
- Turn left onto N. City Pkwy
- Turn right onto S. Grand Central Pkwy
- Turn left onto Bonneville Ave.
- Take a slight right turn and arrive at destination

FROM I-15 NORTH

- Take Exit 41A onto SR-159, Charleston Blvd East
- Turn right onto W. Charleston Blvd.
- Turn left onto S. Grand Central Pkwy
- Turn Right into the parking lot and arrive at destination

FROM I-95 NORTH

- Take Exit 76C to W. Symphony Park Ave.
- Turn left onto W. Symphony Park Ave.
- Turn right onto S. Grand Pkwy
- Arrive at destination

FROM I-95 SOUTH

- Take Exit 76B-76C for Martin L King Blvd
- Use middle lane to keep right at the fork and merge onto S. Martin Luther King Blvd
- Turn left on W. Symphony Park Ave.
- Turn right onto S. Grand Central Pkwy
- Turn left at LV Premium Outlet Dr,
- Destination will be on your left

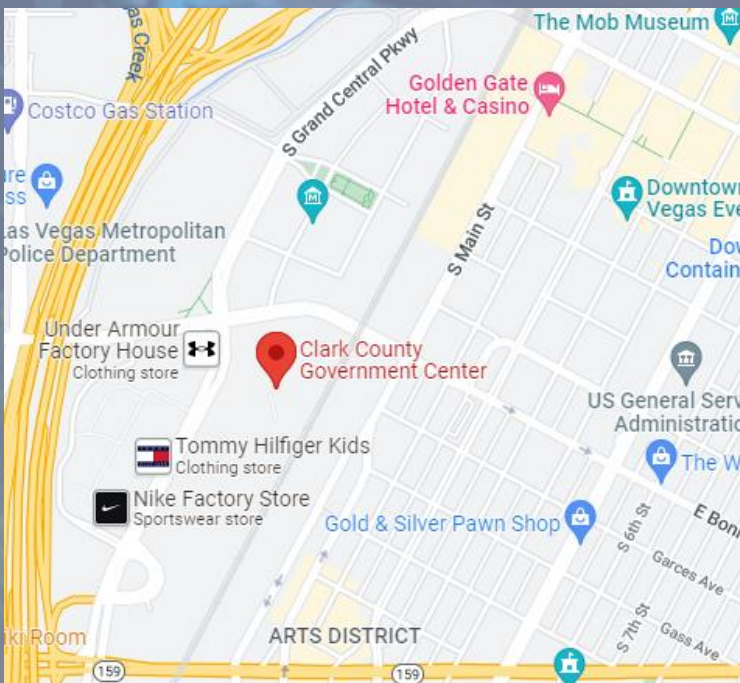

EVENT LOGISTICS

PARKING

Two large parking areas next to the area can easily accommodate **1,300** vehicles for event guests.

SEATING

Lawn seating for **3,000** on three levels surrounds a 50' diameter concrete stage.

RESTROOMS

User may need to rent portable facilities. There is a Pyramid building which could also be rented that includes restrooms.

FENCING

Fencing must be rented if needed.

TECH/PRODUCTION INFO

LOAD IN

A circular load in driveway for vendors is adjacent to the gently sloping grass area tiered by ADA accessible concrete walkways with security lighting.

ROOMS & OFFICE

Two dressing rooms are available backstage with comfortable couches and other seating areas. A Production Office can also be utilized. More detailed info later in packet.

SHOW POWER

200 amps, 3 phase for sound, 200 amps 3 phase for lights.

STAGE DIMENSIONS

50' diameter concrete slab, 4-post truss system with shade cover with 30x30 footprint. Speakers can be flown from truss.

AUDIO SYSTEM

FRONT OF HOUSE

- (1) Midas M32 Digital Mixing Console
- (2) Behringer X32 Digital Mixing Console
- (4) EW 300 IEM G3-B Wireless Monitoring System
- (2) Behringer S16 16-channel Digital Snake
- (1) 300' CAT5e Cable
- (1) MKR-TC-350 DataTuff Belden 7923A Cat5e Cable Reel 350'
- (1) NED-300 300' Edison Cable

MAIN SPEAKERS

- (16) JBL VRX932LAP 12" Powered 2-Way Line Array System
- (12) JBL VRX918SP 18" Powered Flying Subwoofer
- (4) JBL VRZ-AF Array Frame

MONITOR SPEAKERS

- (10) QSC K12 2000w 12" Powered Speaker
- (8) Electro-Voice 12" Passive Speaker
- (4) Electro-Voice 15" Passive Speaker

AUDIO GEAR

WIRED MICROPHONES

- | | |
|----------------------|----------------------------|
| (6) SHURE SM58 | (2) SENNHEISER e905 |
| (7) SHURE SM57 | (5) AUDIO TECHNICA AES5100 |
| (2) SHURE SM57A | (1) SE V KICK |
| (2) SHURE BETA 91 | (1) SE V7X |
| (2) SHURE BETA 52A | (2) SE VBeat |
| (10) SENNHEISER e604 | (2) SE 8 |

WIRELESS MICROPHONES

- (4) SHURE ULXD2 | SM58
- (2) SHURE QLXD4 | SM58

WIRELESS RECEIVERS

- (1) SHURE ULXD4
- (1) SHURE QLXD4

AUDIO GEAR (contd.)

DI

- (6) DT85 Type 85 Direct Box
- (8) DBGL 8 DBGL Pro DI

CABLES

- | | | |
|----------------------------|----------------------------|---------------------------|
| (4) 100ft XLR | (2) 100ft Speakon | (7) 25ft Edison Round End |
| (17) 50ft XLR | (2) 50ft Speakon | (2) Edison Triple Outlet |
| (28) 25ft XLR | (6) 25ft Speakon | (21) Powercon to Edison |
| (27) 15ft XLR | (3) 5ft Speakon | (5) 100ft Powercon |
| (2) 10ft XLR | (6) Quad Box | (6) 50ft Powercon |
| (5) 5ft XLR | (2) 100ft TL5 | (18) Short Powercon |
| (21) 3ft XLR | (2) 50ft TL5 | (1) 50ft Ext Cord |
| (8) 1ft XLR | (2) 12 channel snake | (10) 25ft Ext Cord |
| (18) Short XLR Jumpers | (2) 16 channel snake | (6) VRX Jumper Pairs |
| (11) 25ft Instrument Cable | (2) Powercon stringers | (7) IEC |
| (9) 15ft Instrument Cables | (1) 200ft Edison Round End | (3) 200ft Ethernet |
| (5) 3ft Instrument Cables | (2) 50ft Edison Round End | (2) 25ft Ethernet |

MIC STANDS

- (26) Tall Boom
- (11) Short Boom
- (7) Straight

LIGHTING SYSTEM

FRONT OF HOUSE

ETX Ion XE 20 Lighting Console

TRUSSES

4-post truss system with shade cover with 30x30 footprint. Speakers can be flown from truss.

LIGHTING FIXTURES

(24) Conventional PAR cans (4PAR bars) down and side stage

(30) LEDS (5 LED PAR bars) up and side stage

MOVER LIGHTS

(8) Elation Professional DARTZ 360 Compact
Moving Head Fixture

VIDEO SYSTEM

VIDEO MAPPING

- Epson Pro L2500 25K Lumen Projector with Epson ELPM12 Lens
- 1920 X 1200 (WUXGA) With 4K Enhancement Technology
- Sealed Optical Engine
- 3G-SDI and HD Baset Connectivity
- Aspect ratio supports 4:3, 16:9, 16:10



LED WALL



- Up to 40 STR(O) Outdoor rated panels
- 19.75" squares
- 128 X 128 Resolution per square
- 3.9 Mil Pixel Pitch
- Resolume Software

LIVE STREAMING

STREAMING KIT

- (3) Blackmagic 6K Camera
- (3) Canon EF Lens
- (1) 7" Video Monitor
- (1) ATEM Video Switcher
- (3) Fluidhead Tripod
- (1) Netgear 5 Port
- (3) 25ft HDMI Cable
- (1) 12ft HDMI Cable

DRESSING ROOMS

ABOUT

Two dressing rooms: each equipped with comfortable seating, a mirrored wall, a refrigerator, and bathroom. There are no showers.

PRODUCTION INTERNET

There is private backstage WIFI access. This applies to the Production Office as well. Passwords will be provided upon arrival.

SPECS

Each Dressing Room: 213 square feet
Each Bathroom: 56 square feet



PRODUCTION OFFICE

ABOUT

Office space that can host 2 to 3 people. Features lockable door, phone line, hard internet connection, wireless internet connection, and printer.

SPECS

103 square feet



GOVERNMENT CENTER LAYOUT

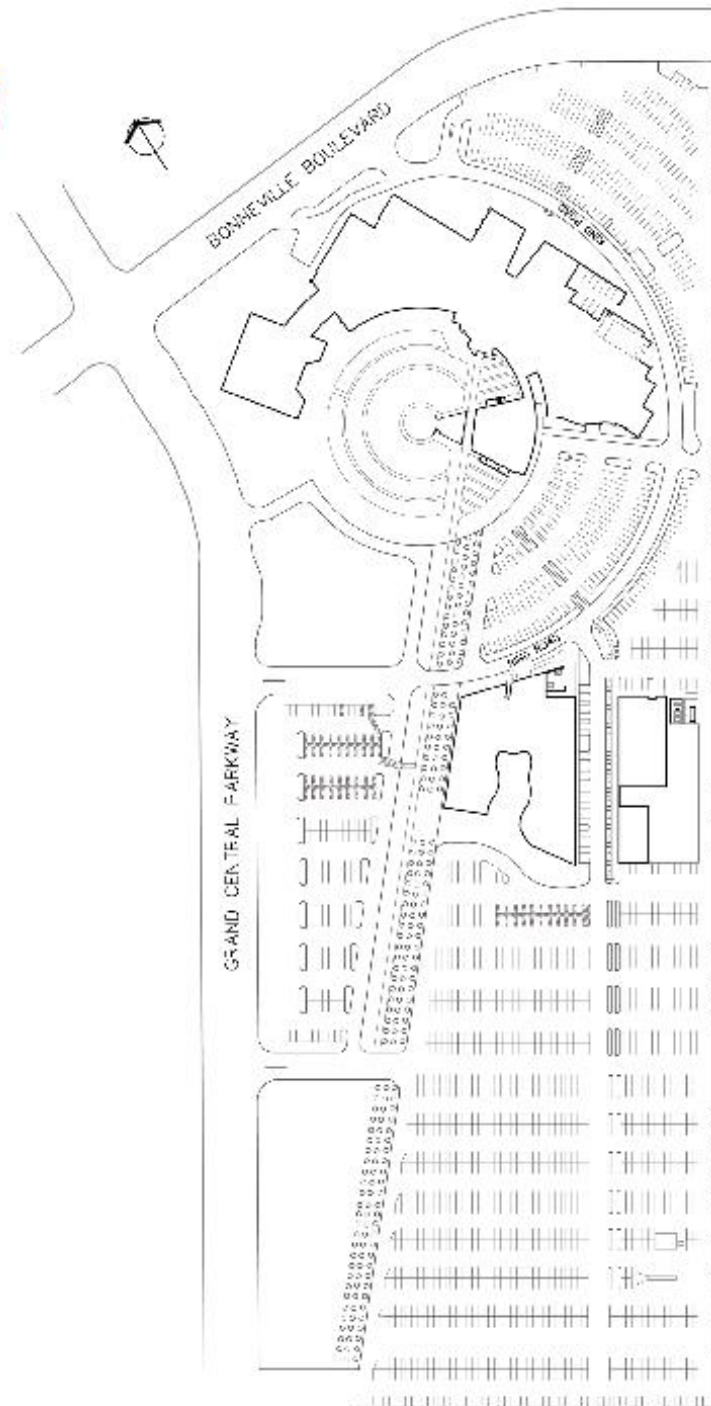

CLARK COUNTY GOVERNMENT CENTER AERIAL VIEW

AMPHITHEATER LAYOUT

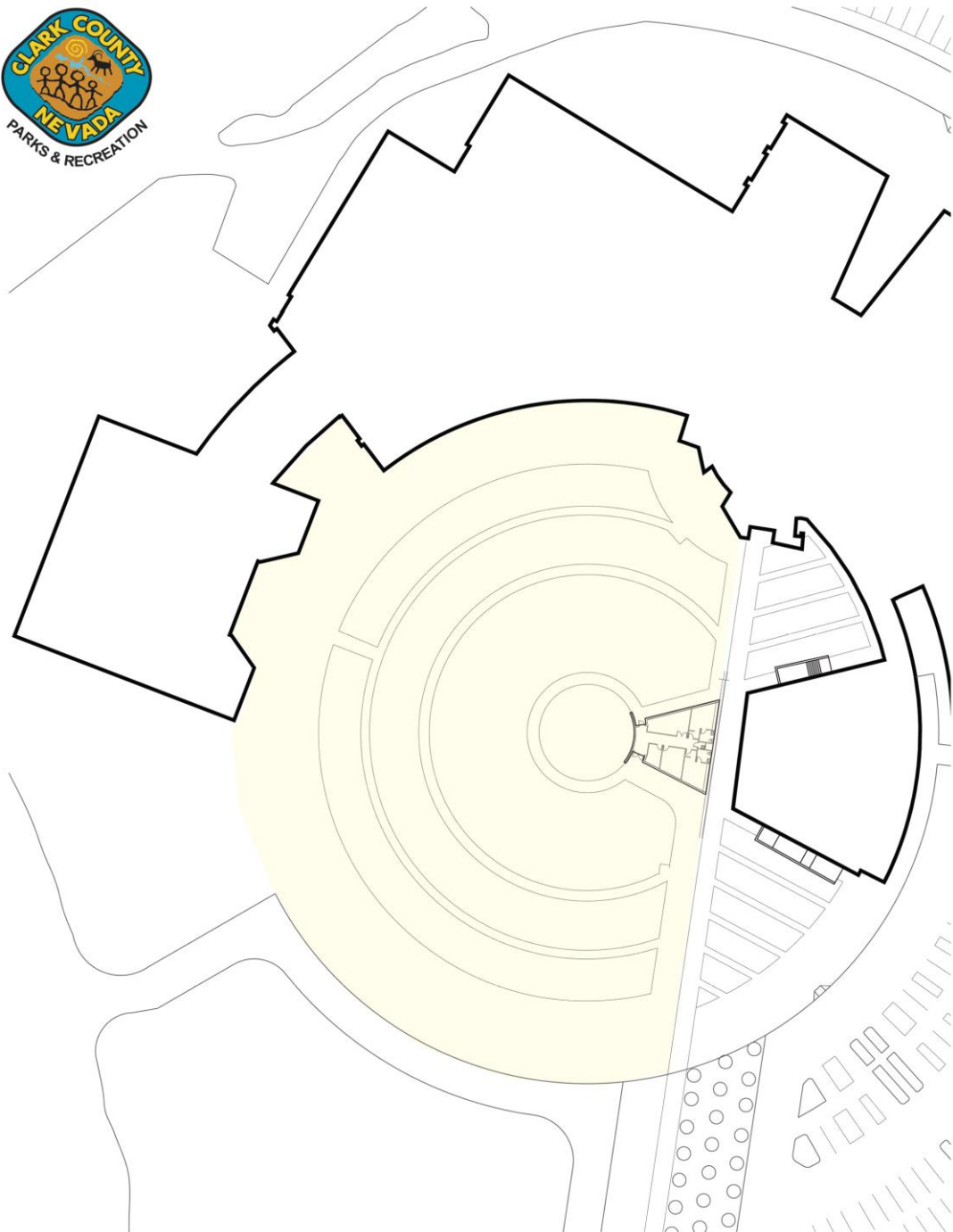

CLARK COUNTY GOVERNMENT CENTER AMPHITHEATER AERIAL VIEW

BACKSTAGE LAYOUT

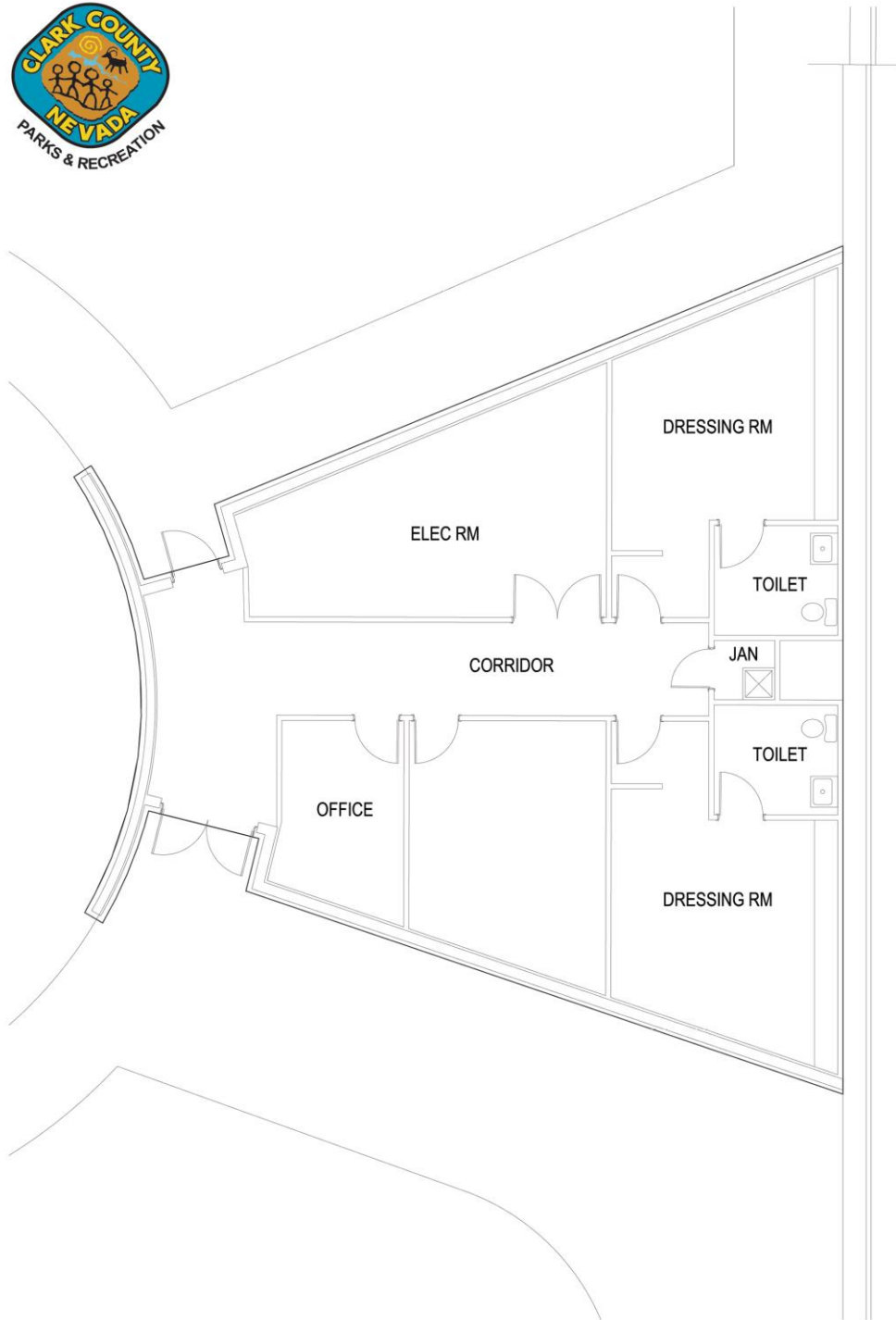

CLARK COUNTY GOVERNMENT CENTER AMPHITHEATER BACKSTAGE

CONTACT US

To inquire about availability and costs you can:

EMAIL: SPERentals@clarkcountynv.gov

CALL: (702) 455-8170